



Assembly Instructions

# LS5004B/VPRB LS1504B/VPRB-50

## Aluminum Bunk Assembly

### PARTS LIST

ref.	part no.	part name	qty.
A	BUNKAV	Bunk Aluminum Assembly	2
B	20676/20902	Bunk Socket Bracket	4
C	20678/20904	Bunk Socket Plate	4
D	20852	Bolt Pkg Step 5	1

# CAUTION

DO NOT INSTALL bunks without studying Owner's Manual.  
Improperly adjusting or overtightening bunks may cause bunks  
to fail and cause damage that is not covered by WARRANTY.

Z129

# LS5004B/VPRB LS1504B/VPRB-50

## tools needed

9/16 Ratchet	1
3/4 Ratchet	1
9/16 Wrench	1
3/4 Wrench	1

1. Install 4 **BUNK SOCKET BRACKETS** and **PLATES** on front and rear **CRADLES** using Step 5 Bolt Package. Each **BUNK SOCKET** Assembly uses:

- 4 - 3/8 x 2-1/2" hex bolts
- 4 - 3/8 nylon locknuts

**PLATES** should be placed on the outside of the **CRADLE** and the **BRACKETS** on the inside. Leave bolts loose to allow for adjustment.

Place a **BUNK DOWN LEG** in each **BUNK SOCKET BRACKET** and hold in place using:

- 1 - 3/8 x 2-1/2" clevis pin
- 1 - hairpin cotter

Determine proper location for **BUNKS** making sure they are equal distance from the center of the cradle. The simplest way to determine this is by measuring the distance between the two inside bunks on your boat trailer. If you do not have a trailer start with each bunk 16" from the center of the cradle (32" apart), or measure to the flat fin on the bottom of the hull closest to the 16" mark. Slide the **BUNK SOCKETS** into position and tighten all bolts.

If you are using the bunks for a Pontoon: Measure the distance between the rib on the bottom of each toon or log. Divide that measurement in half to get the distance from the middle of the cradle to the center of each bunk set. Each pair of bunks should be approximately 6" apart.

2. Adjust **BUNK U CHANNEL** on underside of each **BUNK** to match **BUNK DOWN LEGS** and tighten 3/8 hex nut to hold firmly in place. Do not overtighten!

Place **BUNKS** on top of **BUNK DOWN LEGS** and bolt in place using:

- 4 - 1/2 x 3" hex bolts
- 4 - 1/2 nylon locknut

While holding **BUNK** flat snug bolt so bunk will still pivot under the load of the boat. This will insure that the bunks will conform to your boat. Load boat onto lift making sure that the weight is balanced between the two **CRADLES**. Check and reposition bunks as necessary.

**WARNING : NEVER ADJUST BUNKS WHILE BOAT IS ON LIFT.**

**CAUTION : DO NOT OVERTIGHTEN U CHANNEL. BUNKS MAY FAIL IF NOT ALLOWED TO CONFORM TO YOUR BOAT. THIS WILL VOID YOUR WARRANTY**

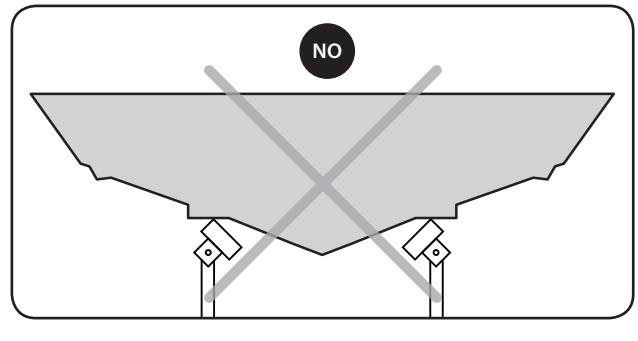
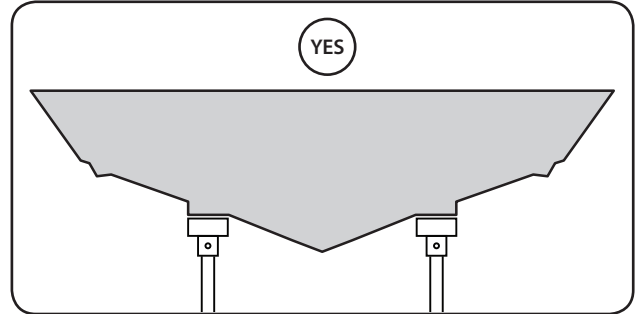

**CAUTION : DO NOT POSITION BOAT SO REAR OF HULL IS IN FRONT OF THE BUNK DOWN LEGS! THIS WILL VOID YOUR WARRANTY AND MAY CAUSE YOUR BUNKS TO FAIL.**

