

LSV15100

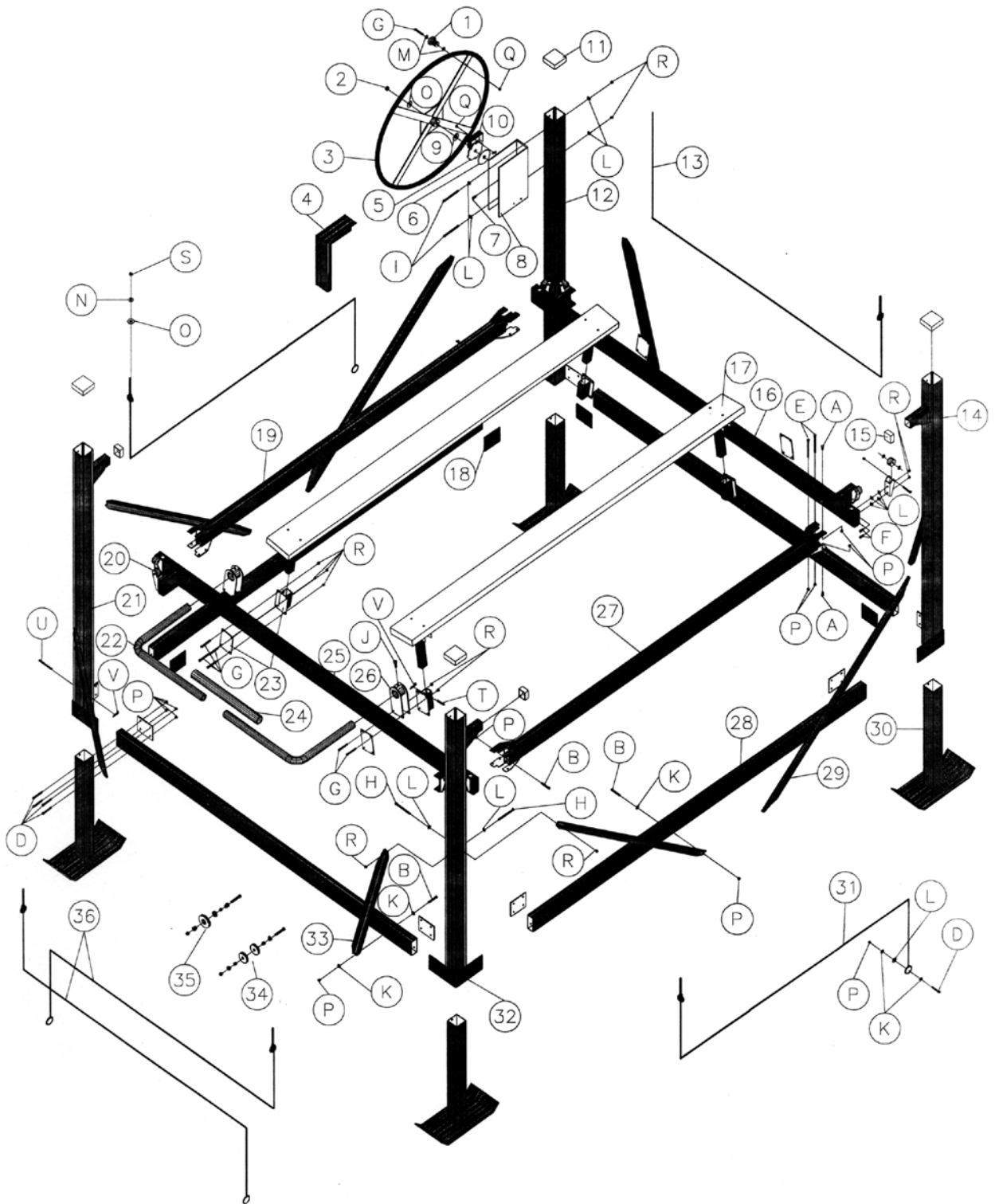

LSV15100 Vertical Lift, 1500 lbs. Load Capacity, 100" Beam Width, 54" Lift Height

PARTS LIST

REF.	PART NO.	PART NAME	QTY.	REF.	PART NO.	PART NAME	QTY.
1	20552	Wheel Knob with Fastening Hardware	1	20	CRA	Cradle Roller Assembly	8
2	Y756	5/8" Jam Nut	1	21	20182	Mainframe Post #4	1
3	41W	41" Wheel - no longer available*	1	22	MSTUBE	Motor Stop L Tube	2
4	WC2	Small Winch Cover	1	23	20553	Bunk Post Socket Ass'y	4
5	WLS	Winch Locking Sproc.	1	24	MSPVC	Motor Stop PVC Tube	1
6	WINCHBP1	Winch Brake Pad	1	25	20203	Rear Cradle Assembly	1
7	20039	Winch Wedge	1	26	20236	Motor Stop Bracket	2
8	W2	Small Winch (#2) - longer available*	1	27	20199	Cradle Spr. Tube-Right	1
9	W952	Bronze Thrust Washer	1	28	20191	Mainframe Spr. Tube	4
10	WSC	Sm. Winch Sproc. Cvr	1	29	20193	Side Angle Brace - 56"	4
11	DEM33	3" x 3" Plastisol Cap	4	30	20208	Leg	4
12	20179	Mainframe Post #1	1	31	20195	3/16" x 164 1/2" Side Cable Galv.	2
13	20196	1/4" x 252" Front Cable Galv.	1	32	20181	Mainframe Post #3	1
14	20180	Mainframe Post #2	1	33	20192	F/R Angle Brace - 40"	4
15	DEM12/CAPS1520	1 1/2" x 2" Plastisol Cap	3	34	20531	Double Pulley Assembly	2
16	20203	Front Cradle Assembly	1	35	20532	Single Pulley Assembly	6
17	BUNK2000	Carp. Wood Bunk Ass'y	2	36	20194	3/16" x 177" Rear Cable Galv.	2
18	20190	Mainframe Backer Plate	8				
19	20199	Cradle Spr. Tube-Left	1				

* Replace with **LS2005B** - Wheel and W5 - Winch.
You must replace BOTH at the same time because of the threads.

BOLTS LIST

REF. NO.	PART NO.	* AVAILABLE LOCALLY	PART NAME	QTY.
A	Y303	*	5/16 X 3/4 Hex Bolt	8
B	Y308	*	5/16 x 2 Hex Bolt	8
C	Y309	*	5/16 x 2 1/4 Hex Bolt	8
D	Y310	*	5/16 x 2 1/2 Hex Bolt	32
E	Y322	*	5/16 x 5 1/2 Hex Bolt	8
F	Y404	*	3/8 x 1 Hex Bolt	16
G	Y410	*	3/8 x 2 1/2 Hex Bolt	21
H	Y415	*	3/8 x 3 3/4 Hex Bolt	8
I	Y418	*	3/8 x 4 1/2 Hex Bolt	2
J	Y507	*	1/2 x 1-3/4 Hex Bolt	2
K	Y352	*	5/16 Flat Washer	24
L	Y452	*	3/8 Flat Washer	28
M	X452	*	3/8 Stainless Flat Washer	2
N	Y552	*	1/2 Flat Washer	5
O	Y752	*	5/8 Flat Washer	6
P	Y351	*	5/16 Hex Lock Nut	56
Q	Y450	*	3/8 Hex Nut	2
R	Y451	*	3/8 Hex Lock Nut	46
S	G550		1/2 Galvanized Hex Nut	5
T	CP		3/8 x 2 1/2 Clevis Pin	4
U	CP2		3/8 x 3 1/2 Clevis pin	4
V	HPC		Hairpin Cotter	8