

LSV46108A

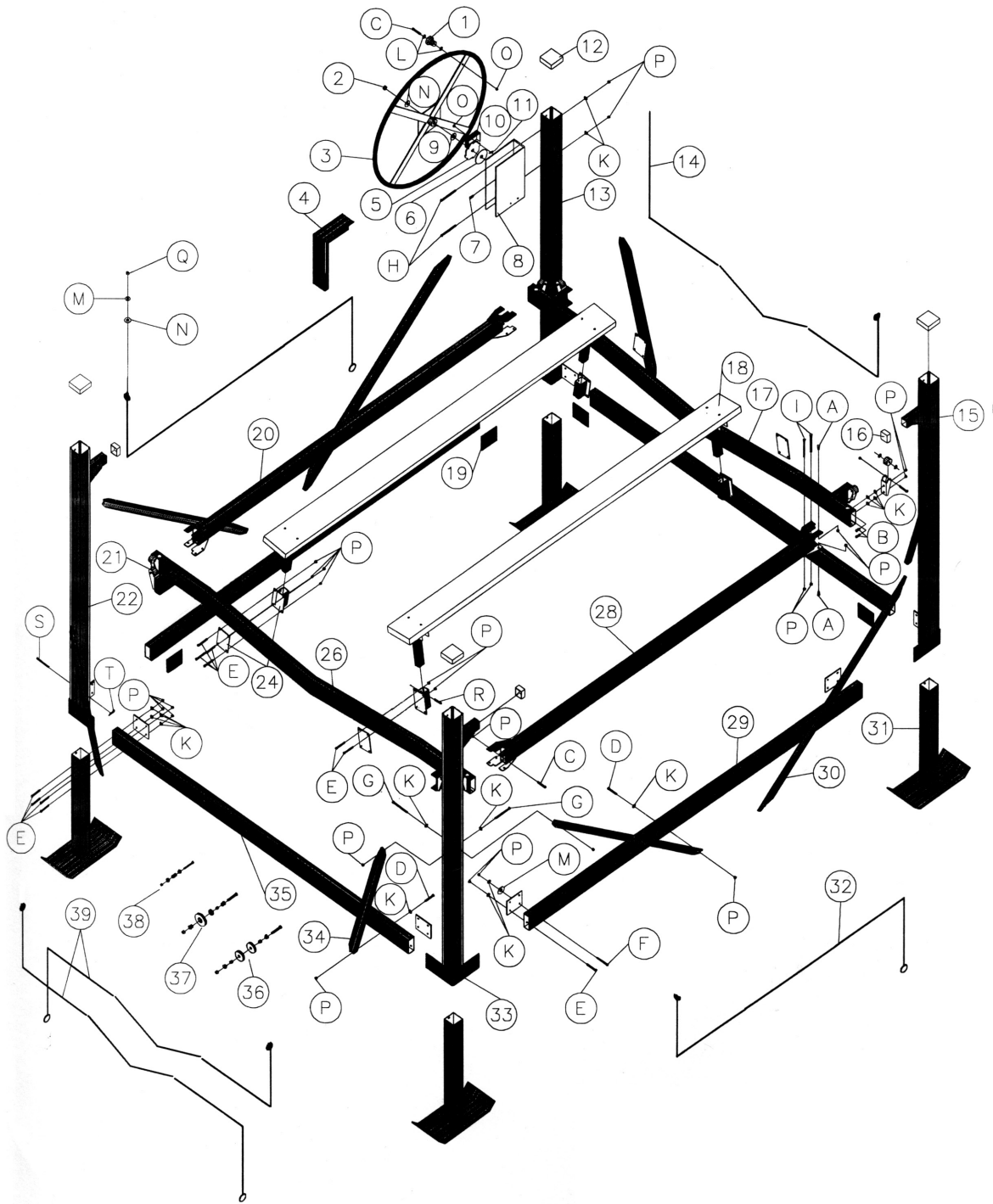

LSV46108A Vertical Lift, 4600 lbs. Load Capacity, 108" Beam Width, 64" Lift Height

PARTS LIST

REF.	PART NO.	PART NAME	QTY.
1	20552	Wheel Knob with Fastening Hardware	1
2	Y756	5/8" Jam Nut	1
3	41W	41" Wheel - no longer available*	1
4	WC1	#1 Winch Cover	1
5	WLS	Winch Locking Sprocket	1
6	WINCHBP1	Winch Brake Pad	1
7	20039	Winch Wedge	1
8	W1	Large Winch (#1) - no longer available*	1
9	W952	Bronze Thrust Washer	1
10	WSC1	Large Winch Stop Cover	1
11	20147	Large Winch Spring	1
12	DEM44	4" x 4" Plastisol Cap	4
13	VMFL1	Mainframe Post #1	1
14	20741	5/16" x 284" Front (A) Cable	1
15	20770	Mainframe Post #2	1
16	DEM25	2 1/2" x 5" Plastisol Cap	3
17	20309	Cradle Weld Assembly	1
18	BUNK4000	Carpeted Wood Bunk Assembly	2
19	VFBP	Mainframe Backer Plate	8
20	VCSTA	Cradle Spreader Tube	1
21	CRA	Cradle Roller Assembly	8
22	20770	Mainframe Post #4	1
24	20119	Bunk Socket Weld Assembly	4
26	20309	Cradle Weld Assembly	1
28	VCSTA	Cradle Spreader Tube	1
29	VMFSTL	Mainframe Spreader 120"	2
30	VAB2	Angle Brace 71.5"	4
31	VL36	Leg 36"	4
32	20767	5/16" x 189" Side Cable (B) SS	2
33	20771	Mainframe Post #3	1
34	VAB1	F/R Angle Brace - 47"	4
35	VMFSTW	Mainframe 108" Spreader Tube	2
36	20148	Double Pulley Assembly	2
37	20149	Single Pulley Assembly	6
38	20150	Roller Bearing Assembly	6
39	20743	1/4" x 189" Rear Cable (C) SS	2

* Replace with **LS2005B** - Wheel and W4 - Winch.
You must replace BOTH at the same time because of the threads.