

# Canopy Frame

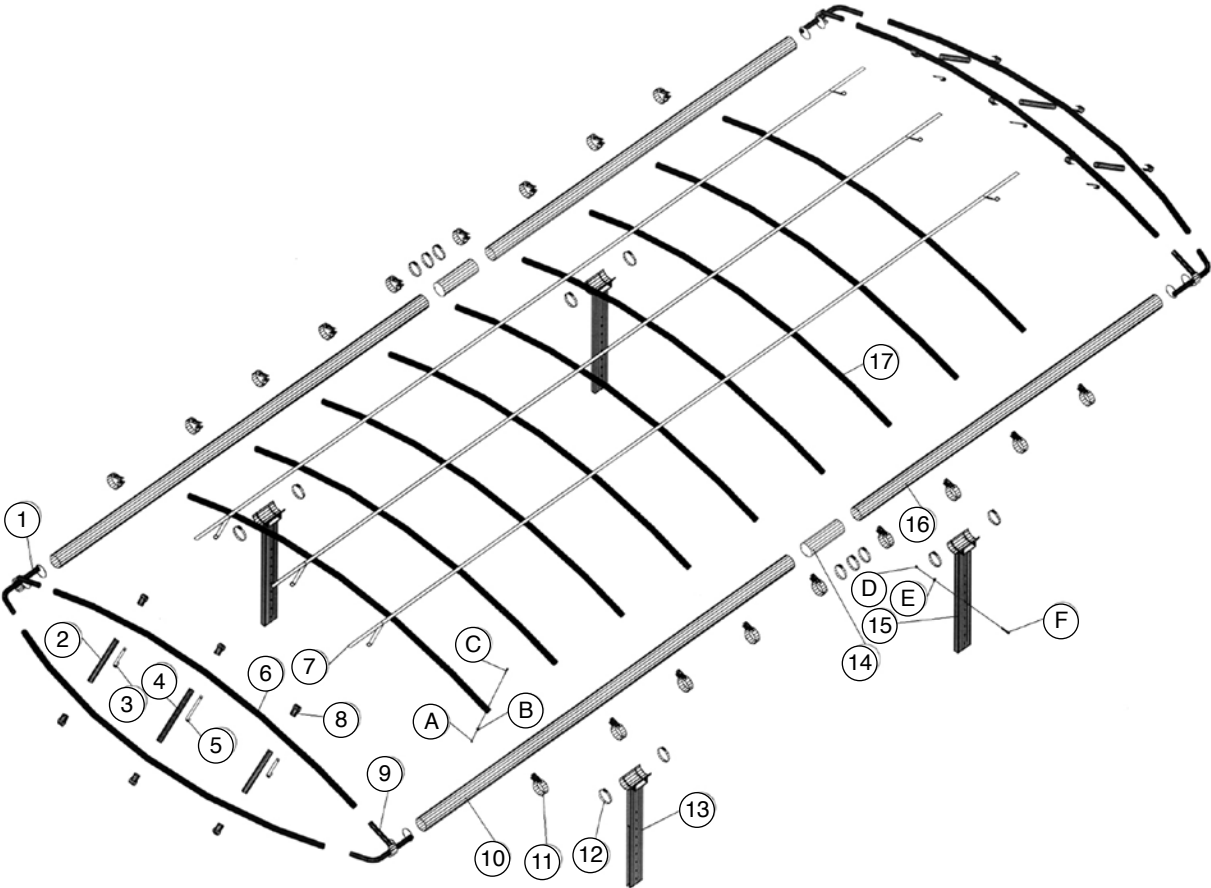

# Canopy Frame

## PARTS LIST

| REF.  | PART NO. | PART NAME              | QUANTITY PER LIFT |         |         |         |         |         |         |         |         | RETAIL PRICE<br>(EACH) |
|-------|----------|------------------------|-------------------|---------|---------|---------|---------|---------|---------|---------|---------|------------------------|
|       |          |                        | 18AF100           | 20AF100 | 22AF108 | 22AF120 | 24AF108 | 24AF120 | 26AF108 | 26AF120 | 28AF120 |                        |
| 1     | LHCB     | Left Corner Bracket    | 2                 | 2       | 2       | 2       | 2       | 2       | 2       | 2       | 2       | \$65.00                |
| 2     | EST      | End Side Tube          | 4                 | 4       | 4       | 4       | 4       | 4       | 4       | 4       | 4       | \$ 5.00                |
| 3     | SGH      | Short Galvanized Hook  | 4                 | 4       | 4       | 4       | 4       | 4       | 4       | 4       | 4       | \$2.00                 |
| 4     | EMT      | End Middle Tube        | -                 | -       | 2       | 2       | 2       | 2       | 2       | 2       | 2       | \$6.00                 |
| 5     | LGH      | Long Galvanized Hook   | -                 | -       | 2       | 2       | 2       | 2       | 2       | 2       | 2       | \$3.00                 |
| 7     | CS18     | Canopy Strap 18'       | 2                 | -       | -       | -       | -       | -       | -       | -       | -       | \$8.00                 |
| 7     | CS20     | Canopy Strap 20'       | -                 | 2       | -       | -       | -       | -       | -       | -       | -       | \$8.00                 |
| 7     | CS22     | Canopy Strap 22'       | -                 | -       | 3       | 3       | -       | -       | -       | -       | -       | \$8.00                 |
|       | CS24     | Canopy Strap 24'       | -                 | -       | -       | -       | 3       | 3       | -       | -       | -       | \$8.00                 |
| 7     | CS26     | Canopy Strap 26'       | -                 | -       | -       | -       | -       | -       | 3       | 3       | -       | \$8.00                 |
| 8     | SGC      | Small Galvanized Clamp | 8                 | 8       | 12      | 12      | 12      | 12      | 12      | 12      | 12      | \$2.00                 |
| 9     | RHCB     | Right Corner Bracket   | 2                 | 2       | 2       | 2       | 2       | 2       | 2       | 2       | 2       | \$65.00                |
| 11    | LGC      | Large Galvanized Clamp | 14                | 16      | 18      | 18      | 20      | 20      | 22      | 22      | 24      | \$4.00                 |
| 12    | SSHC     | SS Hose Clamp          | 14                | 14      | 14      | 14      | 16      | 16      | 16      | 16      | 16      | \$4.00                 |
| 13    | various* | Canopy Winch Leg       | -                 | -       | -       | -       | -       | -       | -       | -       | -       |                        |
| 14    | GCT      | Galv Connector Tube    | 2                 | 2       | 2       | 2       | 2       | 2       | 2       | 2       | 2       | \$12.00                |
| 15    | various* | Canopy Leg             | -                 | -       | -       | -       | -       | -       | -       | -       | -       |                        |
| 10/16 | TUBE7    | Side Tube 7'           | 2                 | -       | -       | -       | -       | -       | -       | -       | -       | \$42.00                |
| 10/16 | TUBE9    | Side Tube 9'           | 2                 | 4       | 2       | 2       | -       | -       | -       | -       | -       | \$54.00                |
| 10/16 | TUBE11   | Side Tube 11'          | -                 | -       | 2       | 2       | 4       | 4       | 2       | 2       | -       | \$66.00                |
| 10/16 | TUBE13   | Side Tube 13'          | -                 | -       | -       | -       | -       | -       | 2       | 2       | 4       | \$78.00                |
| 6/17  | 20241    | Bow Tube 108" w/ holes | -                 | -       | 13      | -       | 14      | -       | 15      | -       | -       | \$32.00                |
| 6/17  | 20242    | Bow Tube 120" w/ holes | -                 | -       | -       | 13      | -       | 14      | -       | 15      | 16      | \$40.00                |
| 6/17  | 20244    | Bow Tube 100" w/ holes | 11                | 12      | -       | -       | -       | -       | -       | -       | -       | \$29.00                |

\* Canopy Leg part numbers will vary depending on Lift Model.